

**Land-WI.com**

**Land-Contract.us**

**Lake-WI.com**



**Cheap WI Land**  
Vacant Land Parcels starting  
at.....\$8,900.



**OWNER FINANCING**  
Land Contract properties are  
starting at.....\$14,900.



**Lakefront & Access**  
Deeded Access Lots starting  
at.....\$19,900.

Visit "The Landman" for Area Information; County Guides + ATV & Snowmobile MAPS!

**NEW Website with 88,000+ Wisconsin Active Listings!**

**IDXWI.com**

This new website allows users to search tens of thousands of WI Listings from 7 IDX systems throughout most of the State. Search by:

**Homes / Condos / Land / Commercial**  
**# of Bedrooms / Bathrooms / Homes Size**  
**Lake Name**  
**Property Size**

**Features & Ammenities**  
**Exterior Features Like Log or Wood**  
**Subdivision / Development Name**  
**Address, City, County or by Map**

You can also setup an account to save searches and setup auto email searches as well. It's all FREE!

**Presented by Landman Realty llc**



## Why List with The Landman?

"According to WI SCMLS Landman Realty llc sells about 1 of every 3 properties we list!"



As you can clearly see from this 3rd party graph, Landman Realty llc is getting 4 to 5 times more web traffic than our main competitor's office websites. Call 888-696-8695 for a Free Comparative Market Analysis which includes a 2 page copy of our marketing plan. Visit [www.TheLandman.net/sellers.html](http://www.TheLandman.net/sellers.html)

**87% of all Home Buyers use the INTERNET to SEARCH for housing**

NAR Survey Results

Landman Realty llc - 888-696-8695 | [www.TheLandman.net](http://www.TheLandman.net)

206 Main St. Friendship WI. 53934

July 4th Weekend 2013

FREE - TAKE ONE



**888-696-8695**

**Vacant Land**  
**Residential Homes**  
**Land Contracts**  
**Log Homes & Cabins**  
**Waterfront & Access**

**OPEN**  
**Personal**  
**Showings**  
Including Most Holidays

**MLS**  
REALTOR

**[www.TheLandman.net](http://www.TheLandman.net)**

Visit our Website to get **ACCESS to 90,000+ IDX Wisconsin Properties!!!**

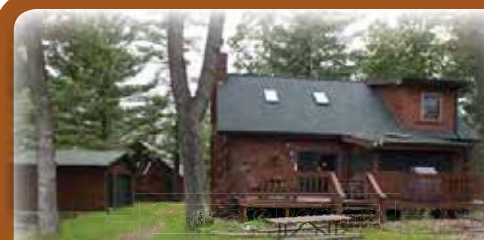

**Custom Log Home + Garages**

3 Bd, 2 ba, full finished basement w/2 matching log garages including 3 lots on ATV routes, Snowmobile Trails, Horseback Riding. **\$299,900.**



**Home 1/3 mile off Road!**

**Survival Home.** enjoy the extreme privacy of this 23 acres way off the road. Hardwood floors, fireplace, full basement, garage, long gravel driveway. **\$224,900**



**12+ Acres - Campers, Well, ++**

Campground-like setting w/ 2 campers, septic, multiple electric posts, trails, sheds, mostly wooded with 500' of trout stream frontage. **\$54,900**



**--- Quality Built Home ---**

2 bd, 3 ba, full finished basement including an office. Cathedral ceilings in the living room / Kitchen / Dining room, built-in security & sound system. **\$175,000.**

**Wisconsin-WI.com**

- County Information
- Real Estate
- GIS Map Links
- Wisconsin Wildlife
- Photos Galleries
- News Feeds
- Classified Ad Section

**Advertising Spots Available**



**2006 Camper on 4.65 ac**

Turn-key camp has large camper with 2 slide outs, well, electric, 2 sheds including one setup like a bunkhouse all on 3 lots by several lakes. **\$34,900.**



**Land Contract**

**160 Wooded Acres - WILDLIFE**

Diverse woods, pine, birch, poplar hardwoods, a little wetland but mostly high and buildable. Plenty of Deer, Turkey, Small Game..... **\$1,800 per acre.**

1. Alpine Hills Lake - Camp or Build - Deeded Access Lot.....**\$10,900.**
2. Lake Petenwell Deeded Access -- Lot PRICE TO SELL --.....**\$14,900.**
3. **1 Acre Well, Septic & Electric - Right by Lake Petenwell.....\$19,900.**
4. 5 Acres - One of the Best Priced Properties **Land Contract.****\$19,900.**
5. **Land Contract** 2 Acres w/Boat Slip on Lake Petenwell.....**\$24,900.**
6. HUGE TREES Camp by Lake Petenwell.....**\$32,500.**
7. 10 Acres just North of Wisconsin Dells **Owner Financing**.....**\$39,900.**
8. 11 Wooded ac by Public Land on ATV route & Snowmobiling.**\$44,900.**
9. 20 Fully Wooded Rolling Acres with Camper....Land Contract..**\$74,900.**
10. 19+WoodedAcresonTroutStreamw/Campers,Well,Septic+++**\$79,900.**

**Feature Your Property in This Brochure - CALL 888-696-8695**





Photo-WI.com

### Castle Rock Lake

Camp by Castle Rock.....**\$14,900**  
Wooded Lake w/Dock Space..**\$19,900**  
List Your Property Here.....**Call Now**

Is Wisconsin's 4th Largest inland body of water with about 14,000 acres of water and a max depth of 36'. Castle Rock Lake was built back in the 1940s for the main purpose of the hydro-power dam. Today, it's one of Wisconsin's most popular lakes. Find Development on the Lake with Photos, Maps, Videos and lots of information. COMING SOON - Boat Launch information, maps photos and videos! More Info & **OVER 200 PROPERTIES** at [www.Castle-Rock-Lake.com](http://www.Castle-Rock-Lake.com)



Photo-WI.com

40+ Acre Parcels starting as low as \$36,750.



**Home & Garage**

3 bd, 2 ba home w/BIG heated Garage on a double lot totaling 1.4 acres close to Big Roche-A-Cri Lake, ATV Routes & Snowmobile Trails. **\$129,900.**



**Land Contract**

**Riverfront by "The Dells"**

2+ acres with access to 38 acre conservancy with a pond. Short Drive to Castle Rock Lake, Wisconsin Dells and Lake Petenwell. **\$29,900.**



**1900+ sq ft Under Assessed Value**

3 bd 2 Bath home with large garage in Dellwood just a couple blocks from Castle Rock Lake. [TheLandman.net](http://TheLandman.net) **\$110,000.**



**Hunting Cabin on 8 Acres**

Hunting Acres close to public land on ATV Route, Snowmobile Trail between Big Roche-A-Cri Lake and the Tri-Lakes. More Acreage Available. **\$54,900.**



**Remodeled Home for Sale**

3 bd, 2 ba, 1660 sq ft home with Garage, Shed and Full Partly Finished Basement located close to Castle Rock Lake. **\$85,900**



**Land Contract**

**The Dells Club Condo**

Fully Furnished Condo right by the Pool, Tennis Courts and Wisconsin River Access. Turn-key 2 bd Condo w/ fireplace on 1st floor. **\$74,900.**



**Wisconsin Wildlife**

Visit [Wisconsin-WI.com](http://Wisconsin-WI.com) to find animals, types of fish & insects that you might see in the state. Information, Fun Facts, Photos and Videos!

- 1. Camp or Build in Dellwood by Castle Rock Lake.....**\$14,900.**
- 2. Secluded - Camp or Build by Fawn Lake - WOODED.....**\$18,900.**
- 3. Small Acreage - Owner Financing - Wis Dells Area.....**\$19,900.**
- 4. Northern Juneau County 4.5+/- Acres on ATV Route.....**\$24,900.**
- 5. 3 Acres Creek Frontage + Access to Lemonweir River.....**\$24,900.**
- 6. CRYSTAL BROOK WOODS - Nature Conservancy.....**\$24,900.**
- 7. Almost 6 Acres with Creek Frontage Camping Allowed....**\$24,950.**
- 8. **20 Wooded Acres in Hilly Terrain with Camper.....\$74,900.**
- 9. 20 Acres w/Massive Trees by Lake Petenwell - Camping **.\$95,500.**
- 10. Place your Property HERE - List with Landman Realty llc.....



**Crystal Brook Woods**

Modern Day Rustic Log Home - Fireplace, Loft, Full Basement, Full Lot, 4 Season Porch, Part ownership 157 Acres. **\$63,900.**



**5.88 Acres on Creek**

Fully Wooded Lot priced to sell in a secluded area of northern Adams County. This area is loaded with deer, turkey & other Wisconsin Wildlife. **\$24,950.**



**Getaway CABIN**

5 Wooded Acres close to Hwy 13 & 21 intersection for great access to the whole area. 2 bd, 1 bath, screened room & detached garage. On ATV route! **\$79,900.**



**Castle Rock Lake - Dock**

Building Site right by Castle Rock has dock space within 1/2 a city block. Nice boat launch within walking distance. **888-696-8695 \$19,900.**



**Affordable Vacation Cabin**

2 bd Cabin with sheds & Bunkhouse in Trout Valley minutes from several fishing lakes, trout streams, some remodeling but needs some TLC. **\$49,900.**



**YOUR PROPERTY IS MISSING**

It could be featured here! List your Central Wisconsin Home, Land, Condo, Commercial Building, Log Cabin or Lake House with Landman Realty llc TODAY! **888-696-8695**



**Adams County WI.**

Visit [Adams-WI.com](http://Adams-WI.com) Information, Photos, Videos on Adams County Lakes, Township, Rock Formations. Enjoy the Events Calendar & Local Directory

- 1. Camp or Build in the Castle Rock Lake Area.....**\$8,900.**
- 2. 4+ Wooded Acres Corner Lot close to Public Land....**\$18,000.**
- 3. LAND CONTRACT 5 Acres N. of Wisconsin Dells.....**\$19,900.**
- 4. Right by Fawn Lake - Gorgeous Woods - Camping OK..**\$23,900.**
- 5. **1 Acre w/Well, Septic, Electric and Paved Driveway.....\$24,900.**
- 6. 10 ac w/ Camper on Top of the Hill - Land Contract.....**\$37,900.**
- 7. LAND CONTRACT 10 Acre right by Lake Petenwell..**\$48,750.**
- 8. Hunting Cabin on 8 ac - NO Well, Septic or Electric.....**\$54,900**
- 9. 22 Acres right by Hwy 13 & 21 Intersection!!!.....**\$119,000**
- 10. 160 Acres Diverse Woods with Pond - Easy Access.....**\$288,000**

2+ Acre Country Cabins & Homes starting as low as 25k



Photo-WI.com

### Lake Petenwell

Deeded Access Petenwell Landing....**\$14,900**  
Wooded Lot w/ Boat Slip....**\$24,900**  
5 Acres by Monroe Town Park...**\$34,900**  
Farmhouse by the County Park..**\$63,900**  
**Lakefront** Petenwell Landing...**\$72,900**

Is Wisconsin's 2nd Largest inland lake with about 23,000 acres of water and a max depth of 44' along the old Wisconsin River Bed. Lake Petenwell is a man made lake which was built in the 1940s by Wisconsin River Power company who owns the hydro-electric dam that provides power to Wisconsin Residences. Now the lake is a premiere recreational lake for boating, sailing, swimming & fishing tournaments. **More Lakefront & Deeded Access Properties at [www.Lake-Petenwell.com](http://www.Lake-Petenwell.com)**



Photo-WI.com