	<b>MLS #:</b> 1626097 <b>Active</b>	<b>Lots &amp; Acreage</b> <b>LP: \$28,900</b>	
	<b>Lot 16 Cherokee Ln</b>	<b>Town</b> <b>Germantown</b>	<b>L08</b>
	<b>County:</b> Juneau	<b>Zip:</b> 53950	<b>State:</b> WI
	<b>Subdivision:</b> Castle Rock Shores		
-----			
	<b>Total Acreage:</b> 0.61	<b>Price/SqFt:</b> 0.00	
	<b>Wooded Acres:</b> 0.61	<b>Number of Lots:</b> 1	
	<b>Pasture Acres :</b> 0.00	<b>Lot Number(s):</b> 16	
	<b>Tillable Acres:</b> 0.00	<b>Section Number:</b> 20	
	<b>Wetland Acres:</b> 0.00		

**Directions:** Hwy 58 N, Right on 37th St, Left on Cherokee Ln to prop on Left.

**School District:** New Lisbon                      **Elementary:** New Lisbon                      **Middle:** New Lisbon                      **High:** New Lisbon

**Utilities Avail:**    Yes            **Specific Builder Required:**    No            **Improvements:**    No            **Special Assessment:**    No

**Legal Description:** CASTLE ROCK SHORES 1ST ADD. LOT 16                      **Lot Size:**    .61 acre per tax rol

**Parcel #:**                      0122223                      **Est. Lot SqFt:**

**Zoning:**                      Resi                      **Net Taxes:**    \$ 438            / 2010

<b>Type</b>	Rural	<b>Purchase Options</b>	Sell entirely
<b>Present Zoning</b>	Single family	<b>Special Assessments</b>	None
<b>Utilities Avail. (To Lot)</b>	Electricity, Telephone	<b>Available Info</b>	Approved plat map, Soil survey, Restrictions/Covenants
<b>Water System</b>	None presently	<b>Miscellaneous</b>	Neighborhood/Addtl Fees
<b>Waste Disposal</b>	None presently	<b>Terms</b>	Cash
<b>Road</b>	Blacktop/Asphalt	<b>Miles to Capitol</b>	Over 50 miles
<b>Improvements</b>	None	<b>Waterfront</b>	Deeded access-No frontage, Dock/Pier
		<b>Lake/River</b>	Castle Rock
<b>Lot Description</b>	Rural - in subdivision, Standard		
<b>Features</b>	Wooded		
<b>Topography</b>	Level		

This beautifully wooded lot is over 1/2 acre and gets you all the amenities that Castle Rock Lake has to offer! Private lake access via the Association outlet, just 1/2 block away. Bring the boat and the waterskis! The launch is just 1 block from here! This flowage offers excellent fishing too! Bring your building plans! There is alot of bang for your buck with this affordable parcel. Seller offers \$500. incentive to assist Buyer with downpayment to be paid at closing. Reserve your spot for summer!

**Sold Price:**                      **PtsPd/SlrCr:**                      **Closing Date:**

*This information provided courtesy of: Landman Realty LLC*

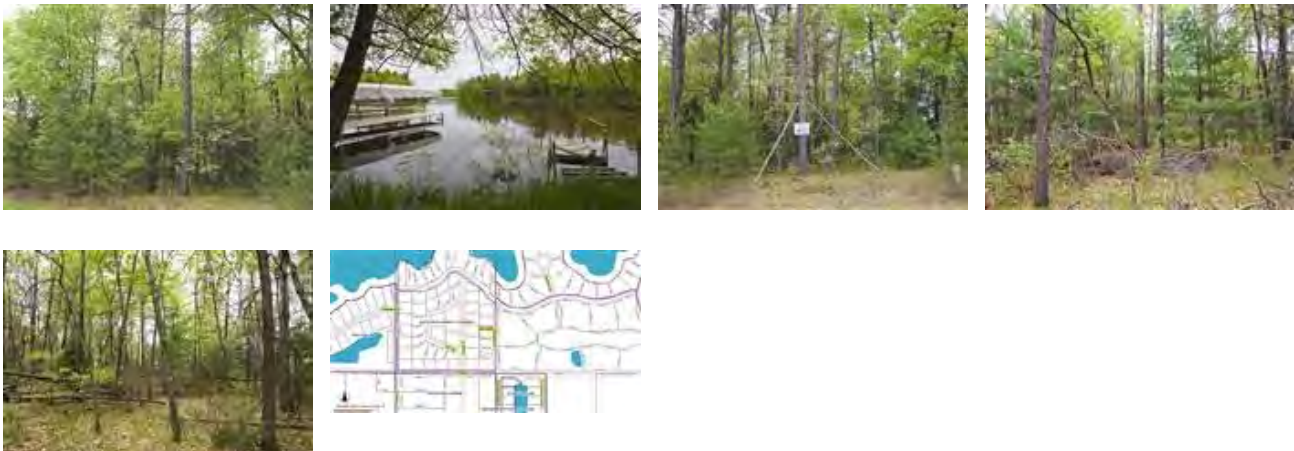

SCWMLS and brokers do not guarantee accuracy of information. All material information must be independently verified by buyer. Equal housing opportunity listing.